

5 FOUNDATION WALL REBAR PLAN
1 1/2" = 1'

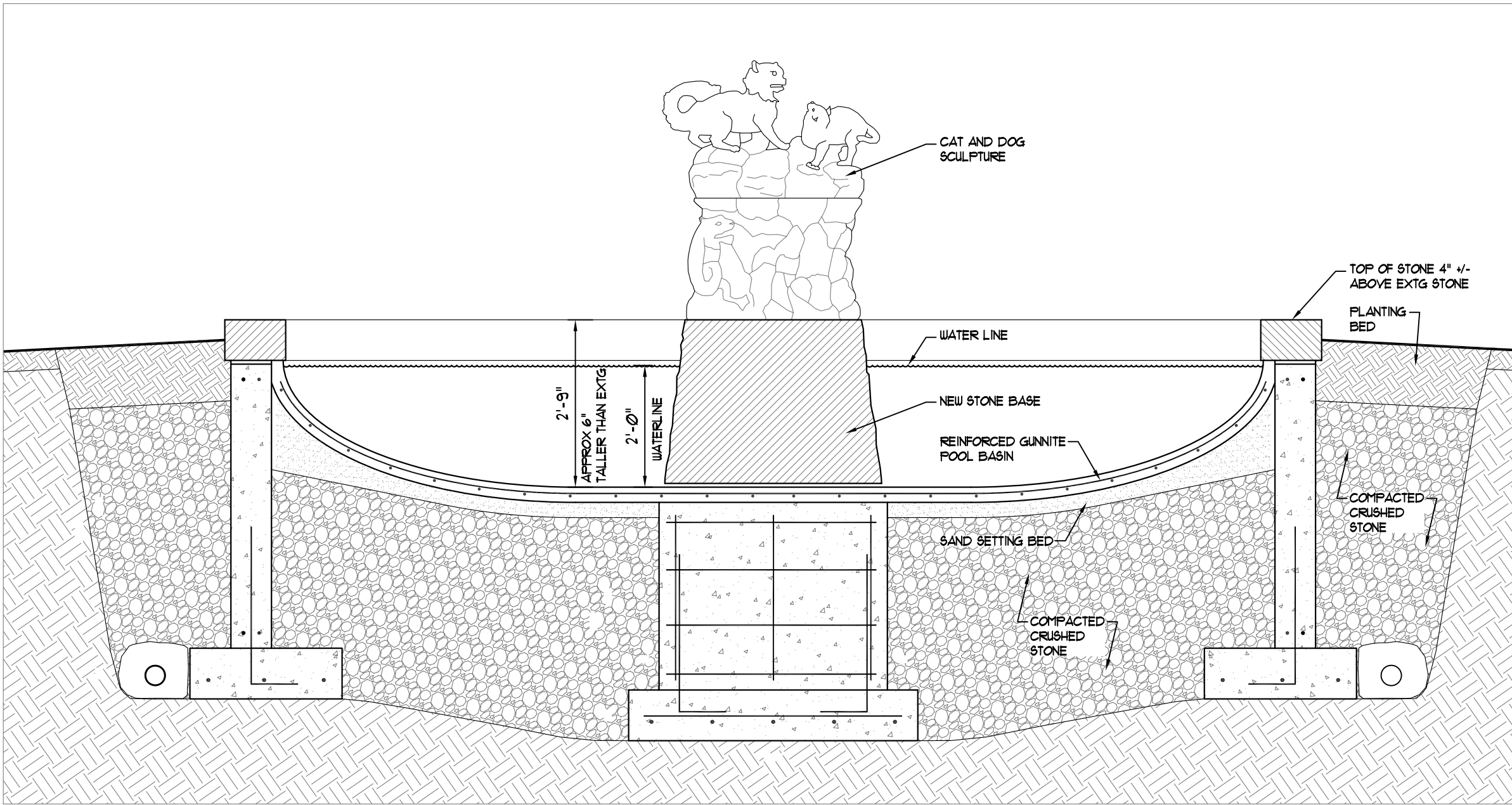

1 FOUNDATION SECTION
1/2" = 1'

CONCRETE NOTES:

COLD WEATHER DEFINITION PER ACI 306R-16:
WHEN AIR TEMPERATURE HAS FALLEN TO, OR IS EXPECTED TO FALL BELOW, 40°F DURING THE PROTECTION PERIOD, PROTECTION PERIOD IS DEFINED AS THE TIME RECOMMENDED TO PREVENT CONCRETE FROM BEING ADVERSELY AFFECTED BY EXPOSURE TO COLD WEATHER DURING CONSTRUCTION.

- ALL CONCRETE WORK SHALL BE DONE IN ACCORDANCE WITH ACI 318 & ACI 306R-16
- ALL FOUNDATION CONCRETE SHALL BE 3000 PSI, 28 DAYS
- ALL SLABS SHALL BE 4000 PSI, 28 DAYS
- 4" SLUMP FOOTINGS, 4" SLUMP WALLS & SLAB
- DOWEL ALL FOOTINGS
- PLACE REBAR PER DRAWINGS
- REBAR SHALL BE ASTM A615, 60 KG6
- SUBMIT CONCRETE MIX DESIGN FOR APPROVAL BY ARCHITECT.
- BACKFILL WITH COMPACTED CRUSHED STONE PER DRAWING
- DO NOT PLACE CONCRETE ON FROZEN OR MUDDY MATERIAL
- ALL SURFACES AND SPACES TO BE FILLED WITH CONCRETE SHALL BE FREE OF SNOW, ICE, AND STANDING WATER BEFORE PLACEMENT.
- MINIMUM CONCRETE MIXING TEMPERATURE SHALL BE IN RELATION TO AIR TEMPERATURE AND SHALL NOT EXCEED TEMPS BELOW BY MORE THAN 5 DEGREES (FOR A LESS THAN 12" CONC DIMENSION)
 - AIR ABOVE 50 DEGREES - MIXING TEMP 60 DEGREES
 - AIR 40-50 DEGREES - MIXING TEMP 65 DEGREES
 - AIR BELOW 40 DEGREES - MIXING TEMP 70 DEGREES
- PLACED CONCRETE SHALL BE PROTECTED FROM FREEZING & KEPT AT 55 DEGREES FOR NO LESS THAN 1 DAYS AFTER PLACEMENT AND SHALL NOT EXCEED 75 DEGREES AT ANY POINT DURING THIS PERIOD.
- PROTECT CONCRETE FROM FREEZING AS SOON AS PRACTICABLE AFTER PLACEMENT.
- ASSURE GRADUAL COOLING OF CONCRETE SURFACES DURING REMOVAL OF PROTECTION TO PREVENT CRACKING DUE TO THERMAL STRESSES.
- DO NOT BACKFILL UNTIL CONC. IS CURED (14 DAYS) AND THOROUGHLY BRACED
- COLD JOINT, SLEEVES, & OTHER LOCATIONS SHALL BE APPROVED BY THE ARCHITECT PRIOR TO CONSTRUCTION.

SCULPTURE GRANITE BASIN
• EXACT DETAIL AND SPECS TBD.

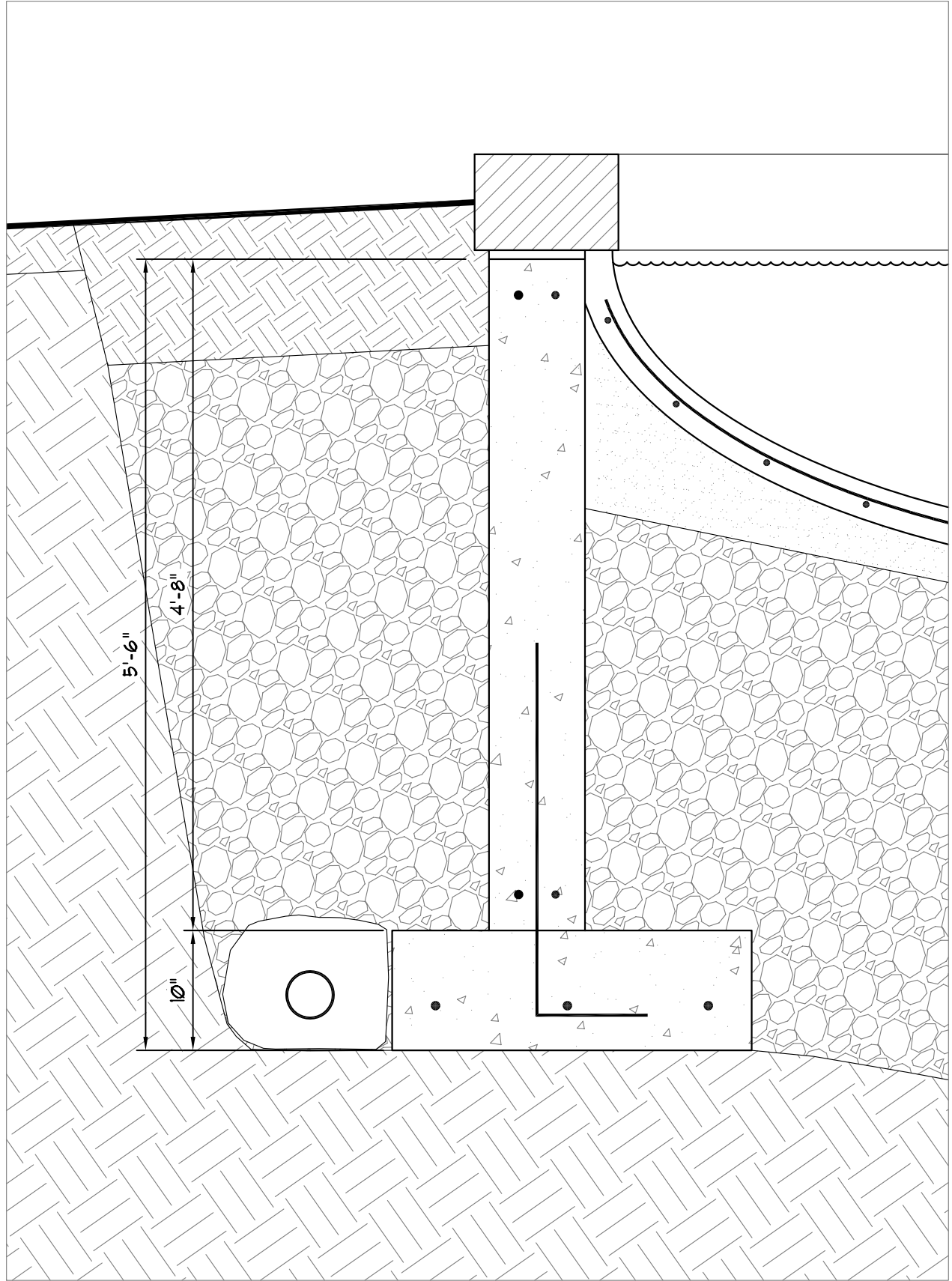

2 FOUNDATION DETAIL
1" = 1'

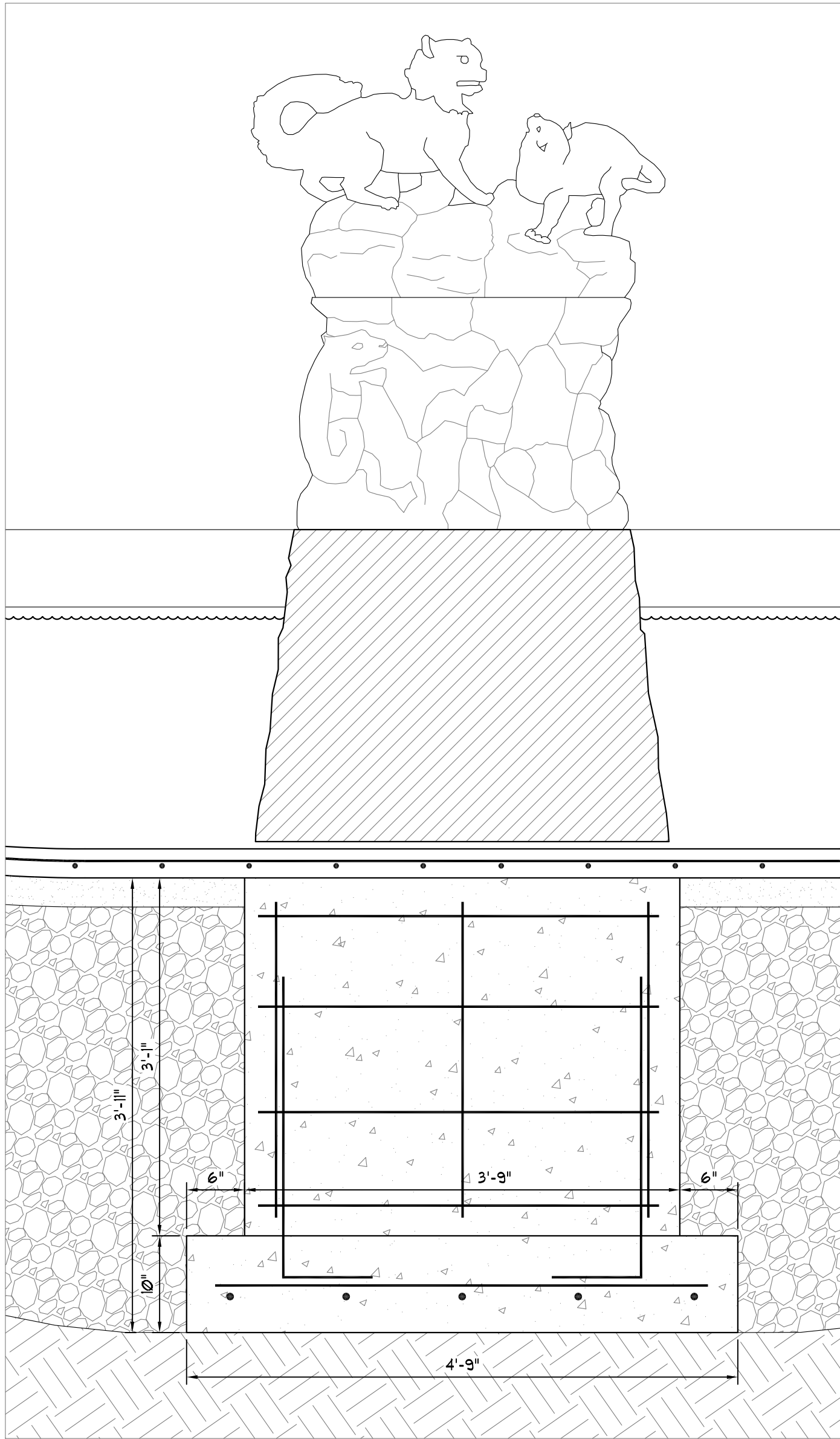

3 FOUNDATION DETAIL
1" = 1'

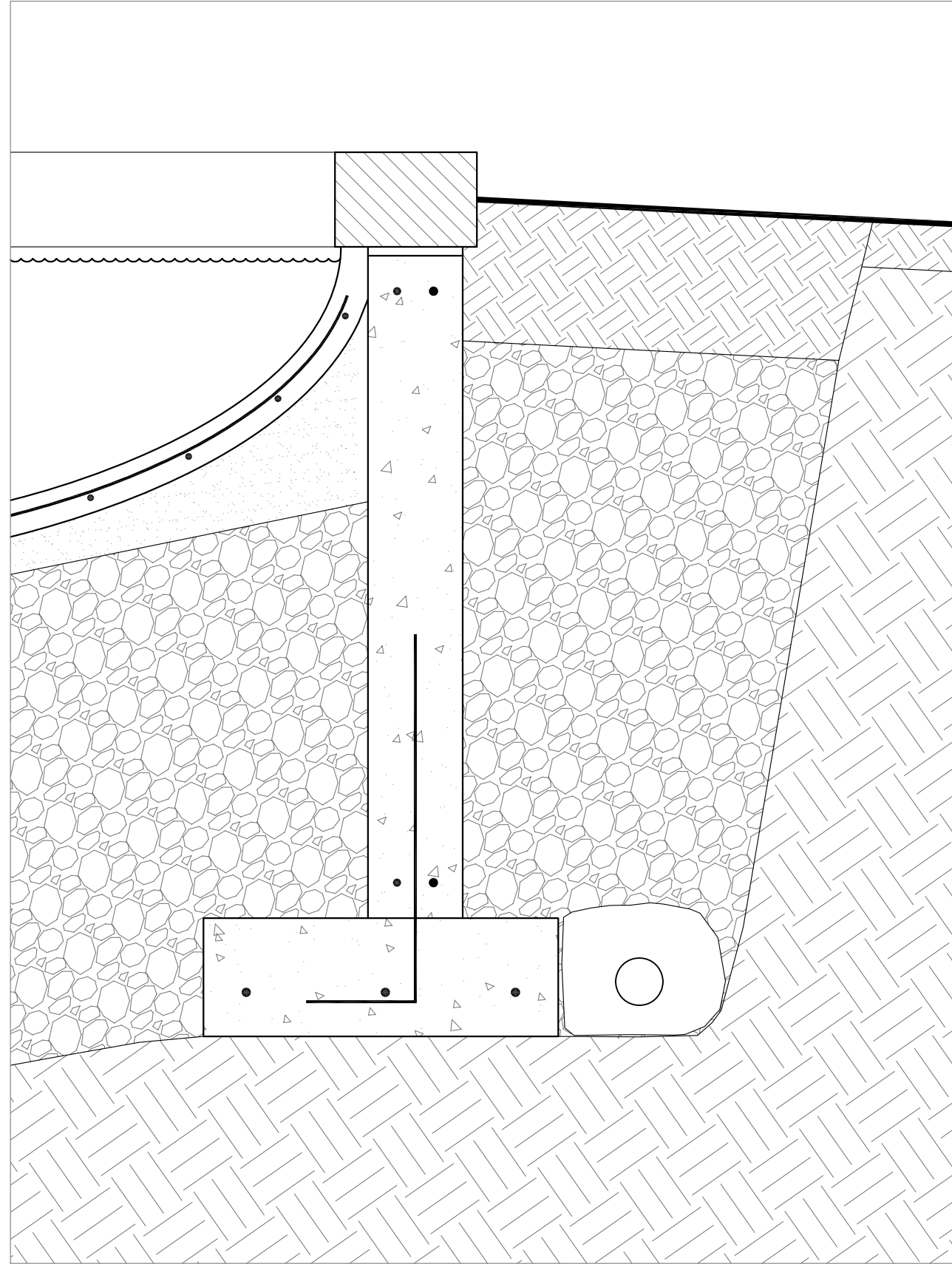

4 FOUNDATION DETAIL
1" = 1'

PROGRESS PRINT

PROGRESS PRINT 5/17/22

FOUNDATION
DETAILS

STOCKBRIDGE
CAT & DOG
SULPTURE

STOCKBRIDGE, MA

A-3